



**Ferguson-Florissant
School District
Reentry Handbook
McCluer
High School
2020-2021 School Year**



Safety
Access
Schedules
Support

TABLE OF CONTENTS

[Letter from Dr. Davis](#)

[Letter from Building Principal](#)

[School Contacts](#)

[Dr. Cedric Gerald \(Principal\)](#)

cgerald@fergflor.org (314) 506-9406

[Arrival Procedures](#)

[Attendance](#)

[Athletics](#)

[Breakfast](#)

[Bus Transportation](#)

[Bus Transportation \(SSD\)](#)

[Classroom Expectations](#)

[Cleaning - Building Readiness](#)

[Dismissal Procedures](#)

[Emergency Drills](#)

[Field Trips](#)

[Gradebook - TylerSISK12 vs Canvas](#)

[Hallway Expectations](#)

[Health and Safety](#)

[Daily Health Screening](#)

[If Symptoms Develop While at School](#)

[HVAC](#)

[Inclement Weather](#)

[Instruction](#)

[Examples of Class Instruction](#)

[Library](#)

[Lockers](#)

[Lunch](#)



[Masks](#)

[Meetings](#)

[Physical Education](#)

[Restrooms](#)

[School Nutrition](#)

[School Hours](#)

[Schedules](#)

[Student Support](#)

[Supplies](#)

[Technology](#)

[Visitors](#)



Letter from Dr. Davis

Dear Ferguson-Florissant Families,

I am excited to welcome you back to in-person learning in the Ferguson-Florissant School District. We have missed seeing you learning and growing in our buildings. We know that nothing beats face to face instruction with students and teachers in the same physical classroom.

It is my hope that this handbook will serve as an important and user-friendly tool for all families navigating our return to in-person learning. In this handbook, you will find much information about how we plan to address health, safety, and instructional delivery within each of our buildings.

While we have been planning for an eventual return for many months, there undoubtedly will be some bumps in the road. I appreciate your patience and support as we move forward together in-person and virtually. Please keep the lines of communication open with your child's teacher and principal, so we can address concerns as we enter this next phase of learning.

Onward together,

Dr. Joseph Davis
Superintendent



Letter from Building Principal: Dr. Cedric Gerald

Dear McCluer Comet Families and Caregivers,

Our whole school community has worked very hard to get to the point where we will start in-person learning for many of our students. We remain committed to providing the best possible learning experience for all of our students, whether learning in person or virtually.

In the coming months as we engage in new and challenging experiences together, please reach out to your child's teachers and I so that we can support your child. Thanks for your support of our school community and I look forward to many bright moments amidst the backdrop of **this** challenging year.

Sincerely,

Dr. Cedric Gerald

Principal

McCluer High School

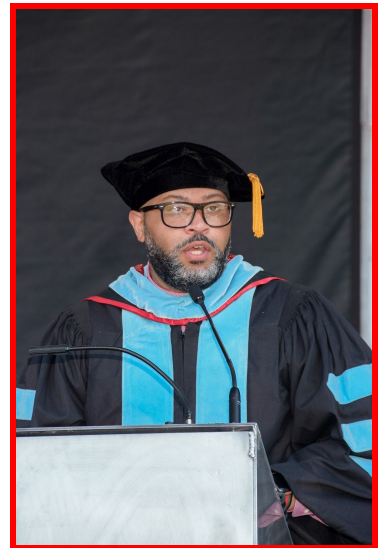

School Contacts

Dr. Cedric Gerald (Principal):	cgerald@fergflor.org	(314) 506-9408
Dr. Tracee Lewis (12th Grade Assistant Principal):	tlewis@fergflor.org	(314) 506-9411
Dr. Courtney Ford (11th Grade Assistant Principal):	coford@fergflor.org	(314) 506-9436
Kurtis Downing (10th Grade Assistant Principal):	kdowning@fergflor.org	(314) 506-9443
Dr. Andrew Emmerich (9th Grade Assistant Principal):	aemmerich@fergflor.org	(314) 506-9457
Willie Eaglin (Dean of Students)	weaglin@fergflor.org	(314) 506-9587
David Kastrup (Athletic Director)	dkastrup@fergflor.org	(314) 506-9440
Andriette (Angie) Williams (SSD Area Coordinator)	awilliams@fergflor.org	(314) 506-9407
Lauren Weissler (Instructional Leader)	lweissler@fergflor.org	(314) 506-9561
Victoria Williams (Social Worker)	vwilliams@fergflor.org	(314) 506-9516
Laura Taylor (Office Manager)	ltaylor@fergflor.org	(314) 506-9408
Joyce Barbre (School Nurse)	jbarbre@fergflor.org	(314) 506-9448
Mary Hembree (Guidance Office OP)	mhembree@fergflor.org	(314) 506-9420
Suzie Krisch (12th Grade Counselor)	skrisch@fergflor.org	(314) 506-9424
Timothy Vanderhoof (11th Grade Counselor)	tvanderhoof@fergflor.org	(314) 506-9429
Allison Bender (10th Grade Counselor)	albender@fergflor.org	(314) 506-9427
Iris McClendon (9th Grade Counselor)	irmcclendon@fergflor.org	(314) 506-9426
Miasha Shannon (Registrar)	mshannonpl@fergflor.org	(314) 506-9418
Michelle Knighton (Attendance OP)	mknighton@fergflor.org	(314) 506-9470
Danielle Banks (12th Grade OP)	dabanks@fergflor.org	(314) 506-9409
(VACANT) (11th Grade OP)		
(VACANT) (10th Grade OP)		
Tina Bell (9th Grade OP)	tibell@fergflor.org	(314) 506-9435
Coletta Blockton (Bookkeeper)	cblockton2@fergflor.org	(314) 506-9966
(VACANT) (Athletics OP)		



Health and Safety

Health and Safety guidelines are outlined in the handbook.

- Masks are required for everyone
- Physical distancing
- Hand washing & Hand Sanitizing
- Walking through the halls
- Breakfast and lunch
- Restroom

Access

All students have access to a Chromebook.

- Canvas Learning Management System will be utilized daily.
- Instruction will be concurrent
 - In-person and virtual instruction will occur at the same time with a teacher
- Students will bring charged devices daily.

Security

- School hours are 7:30 AM-6:00 PM for in-person and virtual
- Arrival and Dismissal are outlined below.

Support

Students will be provided academic, behavioral, and social-emotional needs.

- Instructional blocks all for core instruction and tier II and III supports
- Social-Emotional Curriculum is taught during advisory
- Counselors will continue to support schools



Arrival Procedures

Arrival

Students are not able to have access to school until 7:45 am. Students should not plan to arrive or be dropped off prior to 7:45 am. Students who are dropped off will enter the building on the Elizabeth side of campus, through door 27. Students who arrive on the school bus will enter on the S. New Florissant side of the campus through door 1. Upon arrival, students will have the opportunity to eat, grab and go breakfast. Breakfast will start at 7:45 and end at 8:00. Students may eat in the cafeteria, the upper atrium, or their classroom. To ensure social distancing, **only one student is allowed to sit at a table.** Upon finishing grab and go breakfast, students will go to their first block class. Custodial and Cafeteria staff will clean tables with disinfectant once a student finishes their breakfast; however, we encourage students to clean their own space when they are done eating. At the conclusion of breakfast, the custodial staff will clean and disinfect the cafeteria.



Attendance

In-Person

Although student attendance is always important for academic success, we know during these times our families will be extra cautious sending their child to school when they are exhibiting symptoms that could be contagious. We appreciate your efforts to screen your child daily for symptoms and keep them home if there are any concerns. Please continue to call in any absence and provide information that would be important to the overall health of our school. If your child will be staying home due to illness, please do the following:

- **Call the Attendance Line to report your child's absence (314-506-9470)**
- If your child has a POSITIVE COVID test result, please contact your child's grade level administrator immediately.
- If your child has to QUARANTINE due to close contact with a positive case outside of school, please contact your child's grade level administrator.

Please note: **If your child is experiencing symptoms as noted above, please do not send them to school and call the school to alert them that they are staying home.** We encourage you to reach out to your doctor prior to returning to school. If you have any health questions or concerns, please reach out to your school nurse.

Virtual

- Students are expected to attend class via Zoom at the beginning of each class period to receive instruction from their teacher for that day. Students should refer to the teacher's Canvas page for Zoom links.
- If your child is not feeling well enough to attend class virtually, they should contact their teacher for missed work and instruction.

The Freshman Academy

- Provides a sheltered environment for 9th Graders inside of the M-5 wing of McCluer
- Explicitly teaches academic and behavioral universals
- Extends GRR to include the AVID curriculum and 7 Mindsets Lessons
- Progress monitors graduation cohort in advisory to reduce off-track rate
- Requires that all students take a seminar class that helps them transition to and navigate the high school experience.
- Offer team time for teachers selected to teach in the academy that addresses the different needs of students

The Freshman students will take all of their core classes, and many of their elective classes inside of the freshman academy; they will only exit the academy for lunch and some of their elective classes. These students will have a separate grab and go breakfast station at the entrance to the Freshman Academy. Additionally, these students will have a lunch that is separate from the other grade levels at McCluer.



The goal of the Freshman Academy after re-entry is to support students who are transitioning not only from middle to high school, but also from virtual to in-person instruction.

The students in the freshman academy will dismiss each day through the doors that lead from the M-5 building to the bus lot; they will not be allowed to return to the building once they exit the building for the day. Student athletes will have specific locations to meet with coaches based on their practice areas.

First Floor - Math and Science

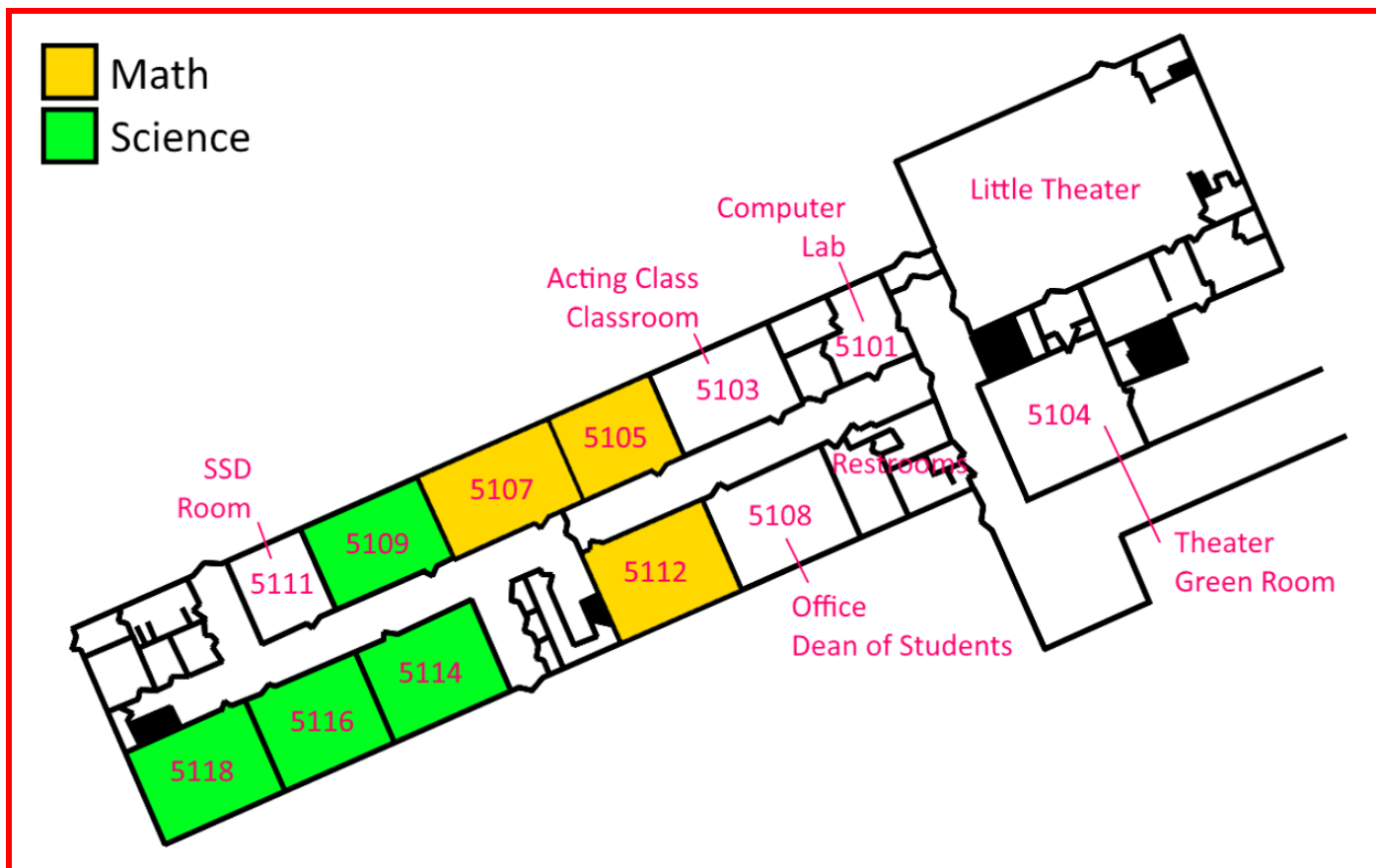

2nd Floor - Social Studies and ELA

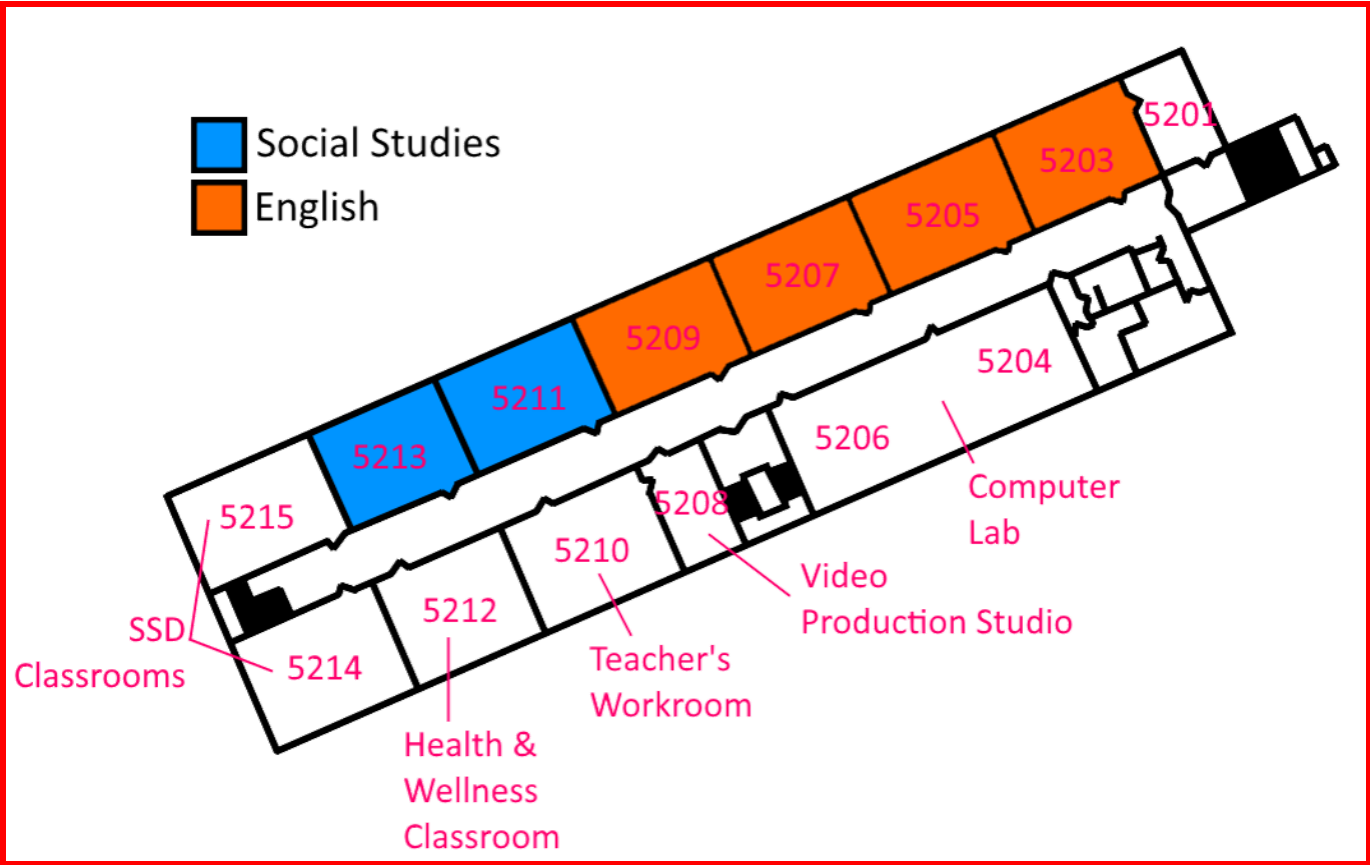

Athletics

In-Person

The athletic department of Ferguson-Florissant

School District continues to balance the importance of activity and athletics for students with the reality of COVID-19 in the country. The district has developed a Return to Play Plan that has been approved by the St. Louis County Health Department. The guidelines were developed to limit the transmission of COVID-19 as students engage in sporting activities and continue receiving quality instruction. We have partnered with the St. Louis County Health Department and the Missouri High School Activities and Athletics Association to outline best practices for our students who engage in athletics and activities. [Return to Play Plan](#)



Virtual

Students participating in virtual learning will need to complete a screener each time they enter the school for practices and activities.

Breakfast

In-Person

Breakfast will be available for students before school starting at 7:45 AM as a Grab and Go. Upon arrival, students will have the opportunity to eat, grab and go breakfast. Students that are dropped off by parents or drive themselves to school will enter on the Elizabeth side of the campus through door 27, or through the lower atrium through Door 17. Students entering through door 27, who wish to participate in Grab and go Breakfast will find Cafeteria staff located at grab and go stations- on both sides of door 27. Students who arrive on the school bus will enter on the S. New Florissant side of the campus through door 1. Students who enter through door 1, who wish to participate in Grab and Go Breakfast will find Cafeteria staff located at a grab and go station just to the immediate right of the door 1 entrance, or students may proceed to the lunch lines that will be monitored for social distancing. Upon finishing grab and go breakfast, students will go to their first block class. To ensure social distancing, only one student is allowed to sit at a table. To ensure social distancing, **only one student is allowed to sit at a table.** Upon finishing grab and go breakfast, students will go to their first block class. Custodial and Cafeteria staff will clean tables with disinfectant once a student finishes their breakfast; however, we encourage students to clean their own space when they are done eating. At the conclusion of breakfast, the custodial staff and food service staff will disinfect and clean the cafeteria.

Virtual

Breakfast and lunch are available on Fridays and students will receive five days worth of meals. The schedule for locations and delivery times can be found on the District website. Virtual students will be



provided a lunch pass that they will need to show in order to be able to pick up a box of meals. A pass will be assigned for each student in a family.

Bus Transportation

Continuing safety measures on our school busses will be important in keeping our students healthy during this time. All bus drivers will be required to wear masks and have minimal contact with students. The interior of the bus will be disinfected with special attention to high touch surfaces. The following will be implemented on buses to ensure proper health safety to reduce the likelihood of spreading disease:

- Students will be required to wear face masks at bus stops and while on the bus at all times.
- When waiting at bus stops, students should maintain at least six feet of social distancing when possible.
- Hand sanitizer will be available upon entry and while riding the bus.
- All buses will be wiped down and disinfected.
- To minimize the spread of germs, buses will be loaded starting at the back of the bus, then moving to the front.
- Same-family households will be expected to sit together in a seat when possible.
- Students will be expected to sit in the same seat going to and returning from school.
- Students should remain in their assigned seats while on the school bus.
- Students receiving SSD transportation at MHS will be dropped off at the M1 Circle Parking Lot where they will be met by SSD staff
- Students will then be escorted to the SSD classroom(s) to receive their Grab and Go breakfast.

Virtual

Transportation is not required for virtual instruction.

Classroom Expectations

In-Person

- Students and staff must wear masks correctly at all times.
- Students should [practice good hand hygiene](#) as they enter and exit the classroom with hand sanitizer. Hand sanitizer will be available in all classrooms.
- Students will be expected to maintain social distance in the classroom.
- Students must sit in seats assigned by the teacher. No mingling or congregating with classmates before or after class.
- Teachers will work to limit unnecessary movement during class.
- Student desks will be separated a minimum of 3 feet to optimal 6 feet in classrooms.
- Students should bring necessary materials for class including school supplies, and Chromebooks fully charged. Students who forgot their Chromebook can check one out in the Library before school starts.
- Students will adhere to all health and safety measures for labs or activities. These measures will include social distancing during activities and hand hygiene before and after.
- In-person students are expected to attend class in-person. Virtual students are expected to attend class virtually. If absent, virtual or in-person, students will need to contact the teacher regarding missed instruction and assignments.



- Students should bring their Chromebooks to class daily.
- Students will continue to use the Canvas platform from which they have accessed their learning all school year.

Virtual

- Students that chose to remain virtual will continue their studies online.
- Follow appropriate online “netiquette” expectations, outlined in the Digital Citizenship Contract for Students
- Stay informed by checking your Canvas account and district email daily, as appropriate
- Establish your learning routine and prepare a space where you can work effectively and successfully. This should include having a quiet space in your home where you can participate in video conversations with others, live lessons, or two-way communication with teachers.
- Prepare a daily schedule.
- Be an active learner, proactively communicating with teachers if you need additional support or may not be able to meet assigned deadlines
- Whenever possible, create balance in your day so that you’re not sitting and/or online for hours at a time
- If you’re going to participate in a Zoom video session, please dress appropriately for school and make sure there is nothing behind you that you don’t want others to see. When using Canvas, only submit audio/video files that are appropriate.
- Engage in all learning with academic honesty and integrity. Do not falsify information about yourself or impersonate others online.
- Ask questions, be persistent, and work to solve problems that may occur. Nothing about this experience is normal, so we must be patient and accept there will be challenges and missteps along the way. Be kind to your teachers and your family members. Don’t be afraid to tell others when you’re frustrated or upset, but know that you can’t simply give up, either. We will be better when we support each other

Cleaning - Building Readiness

In-Person

- All spaces have been cleaned and disinfected and equipped with disinfecting spray or disinfecting wipes for adult use.
- Each classroom has been equipped with a hand sanitizer floor stand and dispenser. Hand sanitizer dispensers have been mounted throughout the building in hallways, office areas, cafeterias, and gyms.
- Custodial staff will disinfect high-traffic areas as often as possible throughout the day, and all surfaces will be cleaned and disinfected each evening.
- Buildings will be thoroughly cleaned each evening with a focus on high-touch areas.
- Restrooms will be checked and cleaned regularly throughout the day and documented on the back of the door.
- Staff is encouraged to utilize the spray disinfectant and paper towels available for use as needed.
- Deep cleaning by custodial staff will occur with the notification of a positive COVID case.

Virtual

Dismissal Procedures

Students will be dismissed through a staggered dismissal schedule to prevent congestion at common exits in the building. Students will exit through the nearest designated exits that lead to the buses each day at dismissal. Students will be expected to remain in their classroom until they are dismissed. Students who are carpooling and are dismissed at separate times should



make a plan to meet at the driver's car if necessary. Students will not be allowed to re-enter the building once the exit for the day.

Late Arrival - If a student is arriving late to school or leaving early, the student will upon entering the building report to the attendance office and speak with Ms. Knighton regarding the student's attendance needs for the day. Ms. Knighton will administer late slips for students arriving after 8:20 AM; students arriving after this time must have a late slip to enter class. Ms. Knighton will also ask for documentation stating the need for an attendance change (leaving early) that day (parent phone call, doctor's note, etc.)

- Early Dismissal students will be released with the pass to exit out of the front entrance after their ride arrives and we receive that information from the attendance office. These students will need to walk down to the security booth where they will meet their ride in the early dismissal lot near the main entrance. Students will not be released from class until they are called out of class by the attendance office.

Virtual

The school day is 8:05 AM - 3:10 PM. Students are expected to actively engage in virtual instruction daily.

Emergency Drills

Each school will schedule planned emergency drills that incorporate social distancing. When evacuating the building for an emergency drill, students will maintain a social distance of at least 3 feet and are required to wear their masks. Once outside students will maintain a three-foot distance from other students.

Field Trips

Schools will participate in virtual field trips only.

Gradebook - TylerSISK12 vs Canvas

Tyler SISK12 will continue to be our official grade reporting system. To accurately understand your grade you should continue to refer to grades in TylerSISK12. In Tyler SISK12, some courses may also have category weights for assignments and assessments to calculate a student's overall progress. Canvas is used as a curriculum management tool. While Canvas can show individual scores for some assignments, it does not show the accurate class average since categories are not weighted and not all assignments are collected and scored in Canvas.

Hallway Expectations

Hallway movement will be limited whenever possible. Students are expected to walk to the right. During class transitions, staff members will monitor students to encourage physical distancing. When in line, students will be reminded to allow 6 feet distance between themselves and others. Teachers will supervise hallway transitions to remind students not to cluster with friends in classrooms or hallways. During the passing period, students are encouraged to move from one class to another without congregating.



Health and Safety

In-Person

It is the goal of the Health Services Department to provide safety and support to all Ferguson-Florissant School District Students and Staff. Nurses and Clinic Aides have been trained on the procedures that should be followed if students or staff should become ill while at school. In addition to our regular health office, our building has a designated isolation room where individuals who may be experiencing COVID-19 symptoms may rest while waiting to be picked up. It is important that students experiencing COVID-19 symptoms be picked up immediately. Please be sure that your contact information is up to date so that we can provide the best care and highest level of safety to our McCluer family.

All who enter the building must wash their hands or use hand sanitizer. In addition to the restrooms, all learning spaces are equipped with stand-alone hand sanitizers. Signage and frequent reminders will be given so that students are encouraged to wash their hands and/or use hand sanitizer frequently.

Health and Safety Information:



Daily Health Screening

Daily screening of students by caregivers is required every day for in-person learners prior to coming to school. The next page has a checklist of symptoms that will help you decide to keep your child at home. If any of the symptoms are left unchecked (your student shows the symptom), the student should remain at home. Expectations and protocols for daily screening will be communicated to families prior to the start of in-person instruction, with regular reminders provided throughout the semester. Please plan to make this daily screening a part of your morning routine.

 **Ferguson-Florissant Morning Routine:**
Screen your child for symptoms so we can keep everyone healthy at school.

- No fever or chills
- No cough
- No shortness of breath or difficulty breathing
- No sore throat
- No headache
- No muscle aches
- No nausea, vomiting or diarrhea
- No new loss of taste or smell
- No runny nose or congestion
- No close contact with a person with COVID-19 in the last 14 days

Sick? Stay Home! 

Source: Missouri Department of Elementary & Secondary Education

If your child is experiencing symptoms as noted above, please do not send them to school and call Ms. Knighton in the attendance office (314) 506-9470 to alert them that they are staying home. We encourage you to reach out to your doctor prior to returning to school. If you have any health questions or concerns, please reach out to our school nurse Ms. Barbre (314) 506-9448

Monitoring Symptoms - [At Home Health Screener](#)

It is important for us to continue to monitor our own symptoms daily to prevent transmission through our classrooms and schools. Families should monitor their child's health symptoms each morning prior to school. If your child is displaying symptoms please, please keep them home.

If Symptoms Develop While at School

Students or staff who develop symptoms suggestive of COVID-19 or those with a positive response to the questionnaire during the school day will be assessed by the school nurse, with the district nurse available for consultation, as needed.



Student Support Time is an opportunity for students to seek additional help from their teachers. Students can seek additional academic, behavioral and social-emotional support. There are multiple opportunities to connect with staff:

- Arrange for a Zoom call with the teacher, counselor, or social worker. Virtual and in-person students can use Zoom in the afternoon to meet with their teacher, counselor, or social worker for additional support.
- Email teacher with questions
- Each instructional block has a designated time for intervention and/or enrichment.

Virtual

Teachers and students will use Canvas for instructional delivery.

Examples of Class Instruction

Teachers will work with both in-person students and virtual students on best practices, curriculum content, and resources. The chart below helps describe how class instruction may look for *virtual* and *in-person* students.

In-Person Students	Virtual Students
Expectations	Expectations
<p>There may be times when your child will be asked to work independently in class so that teachers can work with in-person students.</p> <p>Your child will follow the virtual schedule for the class they are in if they are unable to attend due to symptoms or if they are quarantined.</p> <p>All staff and students will be required to wear masks at all times.</p> <p>Parents will conduct a daily health screening for their children. If students are showing symptoms, parents will keep their children home and communicate their absence.</p> <p>Each class will have a required seating chart.</p> <p>Students will not be allowed to congregate in the hallways before, during, or after school.</p> <p>For health and safety reasons, the building will open at 7:45 am.</p>	<p>Your child needs to log on to the classroom Zoom at the specified time for each class period for attendance and to receive instructions for the class.</p> <p>Teachers may choose to live Zoom lessons with at-home students, or they may serve virtual students with a combination of live Zoom and small group learning (ie. learning that students obtain independently)</p> <p>Students can expect to work independently at times throughout the day.</p> <p>Your child may be included in additional class activities (with students who are virtual) depending on the class or activity that would require them to remain on Zoom for an extended period of time</p> <p>Zoom links are posted on the Canvas landing page for the course.</p>



Expectations for Both Virtual and In-Person Learners

- The classroom teacher is responsible for both virtual and in-person students.
- Both virtual and in-person students work on the same content; however, delivery will vary. Your child may have independent work to complete outside their school day.
- Your child will continue to use Canvas. Your child may have independent work to complete outside their school day.
- Teachers will continue to use Canvas as a communication hub for both virtual and in-person students (Course information page, Inbox, Calendar, Modules [Lessons] Link)
- Teachers will determine how to deliver instruction for virtual and in-person students based on best practices in their content areas.
- Virtual students and in-person students will have a consistent format of assessment.

Library

In-Person

To ensure the continued health and safety of our students while still providing services for students in the library the following guidelines have been established:

- Before School - students may visit the library before school to check out or return materials, study/work independently. Spacing will be enforced. Students will check out Chromebooks from the Library in the morning in the event they do not have one.
- After School - Students may only stay with an assigned teacher or group. Students must remain in the library until dismissal or when their transportation arrives.
- Procedures while visiting the library:
 - Masks must be worn correctly at all times
 - Students should sanitize their hands when entering and leaving the library. Hand sanitizer will be available in the library.
 - Students must sign in and out using the Chromebook station. ID will be scanned.
 - Students should **practice social distancing** while waiting to sign in or out, browsing the shelves, or sitting for independent study.
 - If students are using the library for independent study they will be assigned a specific seat. Seating will be spaced out in the library. Students will not be able to sit and study with friends
 - Students will be able to access the print station (desktop computers) of the library. Students should sanitize their hands before and after using this station.
 - No food or drink will be allowed in the library.

Virtual

The librarian will co-teach with classroom teachers to offer guidance on our e-shelf and databases for reading and research.



Lockers

In-Person

Academic Lockers - Students will not be assigned academic lockers this school year to help improve the flow of traffic in the halls during the passing period and to prevent clusters of students from congregating in high traffic areas. Students should be prepared to carry all necessary items with an appropriate clear backpack (students must provide their own clear backpack).

PE Lockers - Students enrolled in physical education classes should come to school dressed to actively participate in class. Lockers rooms will not be available for students to change before or after PE class.

Athletic/Team Locker Rooms - Athletes should arrive at practice or games dressed in appropriate uniform or gear. Athletes who are unable to go home prior to practice or games will not be given access to locker rooms.

Virtual

School lockers are not utilized during virtual instruction.

Lunch

In-Person

Every student will receive the same lunch. For in-person sessions, lunch will be available as a Grab N Go lunch during designated lunch periods using the same stations that were available to students during breakfast.

Additionally, no additional purchases will be available in the cafeteria during lunch time.

Virtual

Breakfast and lunch are available on Fridays and students will receive five days worth of meals. The schedule for locations and delivery times can be found on the District website. Virtual students will be provided a lunch pass that they will need to show in order to be able to pick up a box of meals. A pass will be assigned for each student in a family.



Masks

In-Person

Masks are required to be worn at all times. If students or staff forget their masks or do not have a mask, a disposable mask will be provided. The most effective masks are made with at least 2 layers of fabric that cover their nose and mouth without large gaps and include ear loops or ties for adjustments. Please note, the following types of masks are not allowed as they are less effective in blocking respiratory particles:

- Bandanas and gaiters
- Masks with a breathing valve or “button” vent

If a student forgets his/her mask or does not have a mask, disposable masks are available and will be provided as needed. Masks will be available in classrooms, at the main office, and in the nurse's office. All masks should be changed if they become wet or soiled, dropped on the floor, or otherwise contaminated. Students will be taught and reminded not to touch the front or inside of the mask and to use the side loops to put on and take off the masks.



Meetings

In-Person

Meetings for student support such as IEP meetings or 504 meetings will continue to be held virtually. Parent-Teacher conferences will also continue to be held virtually. Any other meeting needed should be scheduled in advance with your child's grade level office or guidance counselor.

Virtual

All meetings will be held virtually.

Physical Education

In-Person

The District will make every effort to hold Physical Education (PE) classes outdoors. In the event that PE cannot be held outdoors, classes will take place in a gym, weight room, or a classroom with physical distancing for aerobic activities, while also wearing a mask.

Until further notice, High School students will not change their clothes for participation in PE, and the locker rooms will not be accessible. Please wear proper athletic footwear and attire, regardless of the location.

Students should also be prepared to participate in outdoor classes by wearing proper outdoor attire (jackets, sweatshirts, long sleeve shirts, sweatpants, etc.). During PE classes, all physical distancing guidelines and practices will be followed. During indoor classes, if physical distance guidelines pertaining to physical activity cannot be followed, classes will focus on the cognitive



and affective domains of PE. Examples of these types of lessons would be presentations, reading articles, class discussions, or other methods of learning that do not require physical activity.

All students will be required and encouraged to participate in their assigned PE class, regardless of the class being administered in the live, synchronous, or asynchronous format. Grading criteria will be presented and reviewed by each student's teacher.

Virtual

All students will be required to participate in their assigned PE class, regardless of the class being administered in the live, synchronous, or asynchronous format. Grading criteria will be presented and reviewed by each student's teacher.

Restrooms

In-Person

Restrooms will be open during passing periods. Students should practice social distancing in the restroom, wear masks, and hand hygiene. Hand sanitizer will be available by the restrooms.

Students will be expected to continue to move from class to class during passing periods and avoid congregating with friends during this time. It is important that students do not cluster in halls to allow for maximum space for students to safely and comfortably travel.

Signage will be in place to maintain six feet of social distancing outside of the bathrooms, and to ensure handwashing and/or sanitizer usage.

Our custodial staff will disinfect often with full sanitization.

Virtual

Teachers prefer students to use the restroom during passing periods of the virtual schedule.

School Nutrition

In-Person

For in-person sessions, lunch will be available as a Grab N Go lunch during designated lunch periods. No additional purchases will be available in the cafeteria during this time. Students will be supervised to wash hands before and after eating all meals. Proper sanitation protocols (hand washing or sanitizing prior to consumption; appropriate containers for food waste; physical distancing; not sharing food/drink) will be followed. The use of the cafeteria itself will be determined on a case-by-case basis.

Virtual

The district will continue the healthy school nutrition program our families rely on to both in school students and virtual learners.

Virtual

All students have the opportunity to receive school meals in a safe and comfortable environment so that they are ready to succeed in academic and social activities.



School Hours

In-Person

The school day is from 8:05 AM-3:10 PM. Students may enter the building at 7:45 AM and proceed to their classrooms.

Virtual

The school day is from 8:05 AM-3:10 PM.

Schedules

In-Person

Monday thru Thursday students receive instruction in person. On Friday, students complete asynchronous instruction. They do not attend in person.

Students will be able to access their schedules from the Tyler Portal. A great deal of time, effort, and thought has gone into the process of student placement for the 2020-2021 school year courses were created based on student needs and interests and are balanced. Our class lists are structured to provide equitable class sizes at each level. Moving students is difficult without causing imbalances and inequities; therefore we will not honor requests for change of teacher, lunch, P.E., or study hall.

High School

Virtual students will join each hour at the beginning of class.

A Day Mon. - Thur.			B Day Mon. - Thur			Fridays
	Time	Length		Time	Length	
1st Block	8:05 - 9:30	85 min	5th Block	8:05 - 9:30	85 min	Asynchronous 8:05 - 3:10
2nd Block	9:35 - 11:00	85 min	6th Block	9:35 - 11:00	85 min	
3rd Block 1st lunch	lunch: 11:05 - 11:35 3rd block: 11:40 - 1:05	30 min 85 min	7th Block 1st lunch	lunch: 11:05 - 11:35 3rd block: 11:40 - 1:05	30 min 85 min	
3rd Block 2nd lunch	3rd block: 11:05-11:50 lunch: 11:50 - 12:20 3rd block: 12:25 - 1:05	45 min 30 min 40 min	7th Block 2nd lunch	3rd block: 11:05-11:50 lunch: 11:50 - 12:20 3rd block: 12:25 - 1:05	45 min 30 min 40 min	
3rd Block 3rd lunch	3rd block:11:05 - 12:35 lunch: 12:35 - 1:05	90 min 30 min	7th Block 3rd lunch	3rd block:11:05 - 12:35 lunch: 12:35 - 1:05	90 min 30 min	
Advisory	1:10 - 1:40	30 min	Advisory	1:10 - 1:40	30 min	
4th Block	1:45 - 3:10	85 min	8th Block	1:45 - 3:10	85 min	



McCluer Bell Schedule

Bells	1 st lunch students	2 nd lunch students	3 rd lunch students
7:45	Grab & Go Breakfast 7:40 - 8:05		
8:05 Disinfect and Clean 8:05 - 8:15	1st/5th block 8:05 - 9:30		
9:30	Passing 9:30 - 9:35		
9:35	2nd/6th block 9:35 - 11:00		
11:00	Passing 11:00 - 11:05		
11:05	1st Lunch Shift 11:05 - 11:35	3rd/7th block 11:05 - 11:50 <i>~for classes assigned to 2nd lunch~</i> <i>*students return to class after lunch</i>	3rd/7th block 11:05 - 12:35 <i>~for classes assigned to 3rd lunch~</i>
11:35	Passing 11:35 - 11:40		
11:40 Disinfect and Clean 11:40 - 11:50	3rd/7th block 11:40 - 1:05 <i>~for classes assigned to 1st lunch~</i>		
11:50		2nd Lunch Shift 11:50 11:50-12:20	
12:20		Passing 12:20-12:25	
12:25 Disinfect and Clean 12:25 - 12:35		3rd/7th block 12:25 - 1:05 <i>~for classes assigned to 2nd lunch~</i>	
12:35			3rd Lunch Shift 12:35 12:35-1:05
1:05	Passing 1:05-1:10		
1:10 Disinfect and Clean 1:10 - 1:20	Advisory 1:10 - 1:40		
1:40	Passing 1:40 - 1:45		
1:45	4th/8th block 1:45 - 3:10		
3:10	Dismissal 3:10		

Disinfect and Clean Cafe Hallpassess	Supervision: Passing Time	Lunch	Class
---	---------------------------	-------	-------



Special Education

Special Education Services Students will continue to receive all services as outlined in his/her IEP, regardless of the parent's declaration of "in-person learning" or "virtual learning". The instructional platform for all students will continue to be Canvas and Zoom. In the case of a special education teacher being quarantined and unable to teach, a trained paraprofessional or substitute will provide educational services. All meetings called for the purpose of an evaluation, planning, or determination of services by Special School District staff will be held virtually using the Zoom platform. In advance of the meetings, all attendees will receive an invitation via email including the Zoom link. For building specific information, please contact the assigned Area Coordinator.

Student Support

In-Person

Social Emotional Supports

Addressing the social-emotional needs of students remains an important aspect of McCluer High School and we recognize students will not be ready to engage in formal learning until they feel physically and psychologically safe. Establishing a sense of safety and community may take weeks or even months and all staff are prepared to provide support. As we re-enter school, we will create an intentional focus on social and emotional skill building, mental and behavioral health, personal safety and self-regulatory capacity, which likely regressed due to the lack of social interactions between peers and teachers. If you would like someone to contact you for additional support for your child(ren) please use this [link](#) to make your request. A district representative will contact you within 72 hours.

Focus Priorities: Connections, Relationship Building, & Routines

- Collaboration between the Ci3T Core Team, counselors, administration, and teachers.
- 6-12 advisory teachers will deliver 7 Mindsets lessons and team building activities.
- PK-12 teachers will facilitate community building circles.
- [School Counselors](#) will deliver lessons to students about exploring and handling feelings, provide individual and small group counseling, and make referrals to outside agencies as needed.
- [School Social Workers](#) are available to assist your family as your student(s) transition back to school
- St. Louis Children's Service brings specialized services and programs to our schools through our [partner agencies](#) and are ready to support students with mentoring and counseling.

Guidance Office Procedures

Guidance services will continue to be available to students for academic, behavioral and social emotional support. Students will be encouraged to make an appointment with their counselor to provide the least disruption to their academics and classes. Students can make an appointment by emailing their counselor or stopping by the guidance office. For quick questions students are encouraged to email their counselor directly. Drop in services will still be available for any student needing immediate assistance.

Virtual

Supplies



Items to Bring to School:

- Chromebook fully charged everyday
- Extra masks
- Clear Backpacks
- Water bottle
- Hand Sanitizer
- Headphones
- Necessary class materials for the day

Technology

Students will be expected to bring Chromebook to class every day, fully charged. At Home students will be expected to log in to each class via Zoom at the beginning of each hour. If students have an issue with their Chromebook they should do the following: .

For Chromebook Tech Support, please click the link.

- <https://onedistrict.fergflor.org/service/portal.asp>
- or call the Help Desk at 824-2299

Visitors

The District campus will be closed to all visitors. Parents/guardians visiting campus for any reason other than arrival and dismissal must continue to meet virtually.

The front office is closed to non-essential visitors. Parents need to call the school office to check a student in or out. We ask parents to please remain in the car, and a staff member will ensure your child safely reaches your car upon parent request. For safety reasons, recent graduates will not be allowed to visit.

It is important to remember:

- Families must drop students off outside of the building and are not allowed to walk their child inside.
- Drop-offs must be as brief as possible.
- Visitors will not be allowed inside the building.
- Staff members will be present to ensure students safely enter and exit the school.

